



G31AS is an industrial IEPE accelerometer permitting vibration measurements. G31AS features an annular shear ceramic crystal which exhibits excellent output stability over time. The accelerometer incorporates an internal circuit with in a two-wire IEPE system which transmits its low impedance voltage output through the same cable that supplies the constant current power. Signal ground is internal shielded and isolated from the outer case of the unit. Polarity inversion protection for the amplify circuit is inherent in the circuit design. The welded stainless-steel construction provides a hermetic housing. The standard MIL-C-5015 glass insulated connector provides long-term stability over the operating temperature range. In addition to adhesive mounting, G31AS has 1/4-28 threaded holes for stud mounting on the test object. The G31AS provides wide frequency response and shock resistance, which is ideal for industrial vibration monitoring under incidental shock environment.

Features:

- Rugged design
- Corrosion resistant
- Hermetic seal
- Case isolated
- EMI / RFI shielded
- Shock resistance

Application:

- Windmill machine
- Gear box monitoring
- Bearing detection
- Machine monitoring

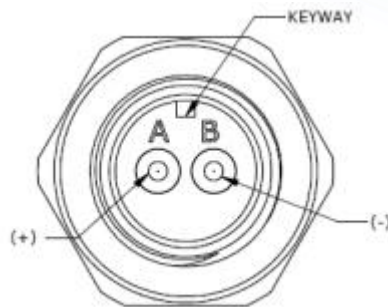
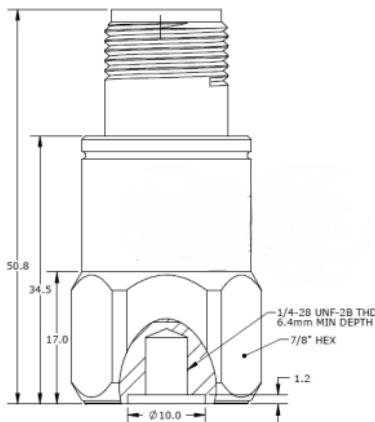
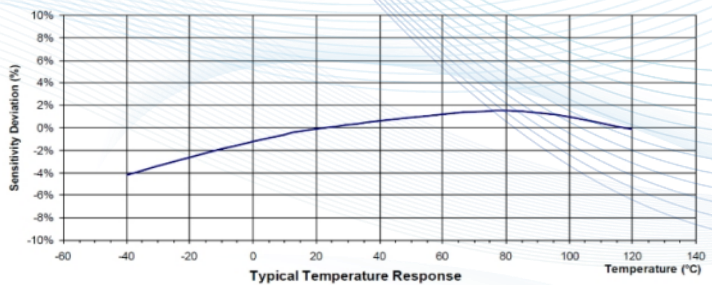
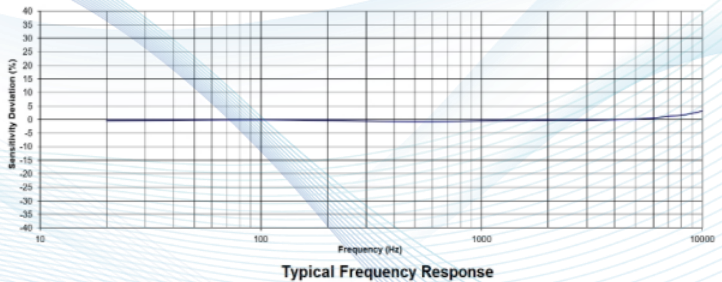
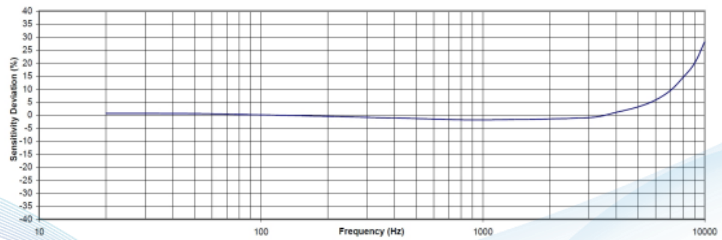

Specification :

Dynamic performance	Unit					
Measurement Range	g	5-LF	10-LF	20	80	500
Sensitivity $\pm 10\%$	mV/g	1000	500	250	100	10
Frequency Range $\pm 10\%$	Hz	0.3~4000	0.3~4000	1~7000	1~7000	1~7000
Frequency Range $\pm 3\text{dB}$	Hz	0.1~10000	0.1~10000	0.5~15000	0.3~15000	0.3~15000
Resonant Frequency	kHz	20	20	32	32	32
Transverse Sensitivity	%	<5				
Non-Linearity	% FSO	± 1				
Shock Limit	g	2000	2000	5000	5000	5000

Environmental parameters

Temperature response -55 ~ +125°C	%/°C	± 10				
Operating and Storage Temperature	°C	-55~125				
Bias Voltage	Vdc	10 ~ 14				

Electrical characteristics

Output Impedance	Ω	< 100				
Insulation Resistance	M Ω	> 100				
Supply Voltage	Vdc	18 ~ 30				
Supply Current	mA	2 ~ 10				

Physical properties

Weight (Excluding Cable)	Grams	87	87	80	80	80
Housing Material	316L Stainless Steel					
Sealing	Laser welded seals					
Sensing Element	Piezo Ceramic					

Random accessory

HS004	Mounting stud ¼-28 to ¼-28 thread	One stud Included
HS005	Mounting stud ¼-28 to M6 thread	
HS006	Mounting stud ¼-28 to M10 thread	Optional
IS006	Adhesive mounting adapter	Optional
AM003	3 channels IEPE signal conditioner	Optional
AM004	Portable vibration analyzer	Optional
AM005	8 channels data acquisition system	Optional

Optional cables

16A	Single axis accelerometer cable, with MIL-C-5015 connector	Optional
16A-B	Single axis accelerometer cable, with MIL-C-5015 to BNC connector	Optional

Ordering information:

G31AS	LF	ZZZ
Range 0005=5g 0010=10g 0020=20g 0080=80g 0500=500g LF=Low frequency response Blank=Standard FR A=IEPE Output		

E.G:

G31AS-50

Model G31AS, 0050, Connector, No Options

G31AS-50A

Model G31AS, 0050, Connector, IEPE

The data contained in this document is intended for the use of technical trainers only. The customer's technical department is responsible for assessing the suitability of the product for the intended application and the completeness of the product information given in this document in relation to such application. For further information on products, technology, terms and conditions of delivery and prices, please contact our nearest office (www.senstechxyz.com).

中国大陆
西安鑫源宇通电子科技有限公司
陕西省西安市高新区锦业路70号航天恒星园区1号厂房一层南
Tel: 400-780-9688
sales@senstechxyz.com

中国香港
深大实业有限公司
香港新界沙田安平街6号新贸易中心B座13楼06室
Tel: +86 1779209916
info@caltropinstruments.com

新加坡
深大实业有限公司
香港新界沙田安平街6号新贸易中心B座13楼06室
Tel: +86 1779209919
info@senstechxyz.com



西安鑫源宇通电子科技有限公司 | 400-780-9688
鑫源宇通——专业的传感和系统解决方案供应商

www.senstechxyz.com