



## Features:

- Hermetic seal
- DC response
- 2 to 500g full scale
- Extreme low noise
- High frequency response
- Excellent thermal stability
- Motion, low frequency, tilt
- 5K g shock survivability

## Application:

- Flight test
- Automotive road testing
- Civil engineering structures
- Railway comfort
- Aviation and aerospace

Model P80AS is a high-sensitivity, low noise accelerometer which measures acceleration and low-frequency vibration. P80AS is a capacitive accelerometer family utilizes a silicon Micro-ElectroMechanical System (MEMS) variable capacitance sensing element. The sensing element consists of a very small inertial mass and a flexure element cantilever positioned between two plates. As the mass deflects under acceleration, the capacitance between these plate changes. AC excitation and synchronous amplitude demodulation circuitry contained in the accelerometer's internal signal conditioner provides an analog output signal proportional to the applied acceleration. This output signal is scaled as a voltage which is proportional to the applied acceleration. The output signal format is single-ended  $2.5 \pm 2V$ . The accelerometer is powered by a single regulated supply between 8 to 36 Vdc. Thermal drift has been compensated by internal circuit for the best environment stability. The sensing element and electronics are contained in a lightweight hermetic housing with a 4-pins connector. The mating cable 13M1-L terminated by pigtails or specified connector(optional) is available. Signal ground is isolated from the test object. The accelerometer can be mounted by M3 metric screw or adhesive. P80AS is well-suited for a wide variety of R&D applications requiring precision measurements and packaging for demanding application and handling needs.

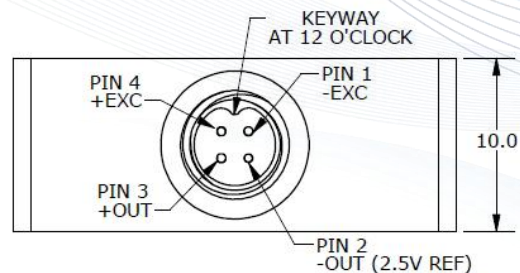
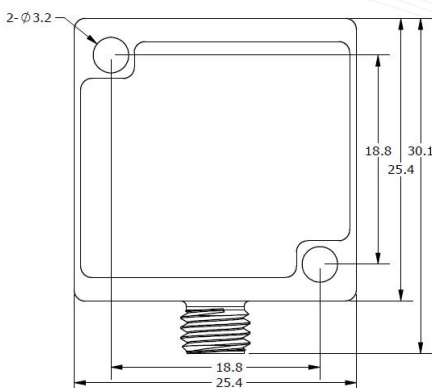
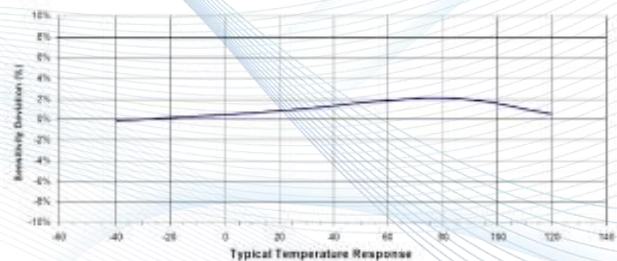
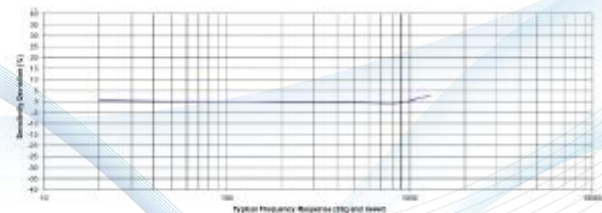
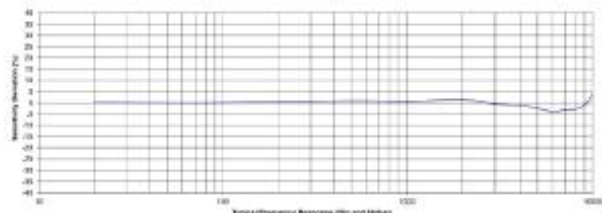

## Specification:

Dynamic Performance	Unit								
Measurement Range	g	±2	±5	±10	±20	±30	±50	±100	±500
Sensitivity ±10%	mV/g	1000	400	200	100	67	40	20	4
Frequency Range ±5%	Hz	0 ~ 800					0 ~ 4500		0 ~ 7000
Frequency Range ±3dB	Hz	0 ~ 1300					0 ~ 10000		
Resonant Frequency	kHz	38							
Transverse Sensitivity	%	<5							
Non-Linearity	% FSO	±1							
Shock Limit	g	5000							
Environmental Parameters									
Temperature Sensitivity Coefficient -40 ~ +125°C	%	±2.5							
Operating And Storage Temperature	°C	-40~125							
Bias Voltage	Vdc	2.5							
Electrical Characteristics									
Output Impedance	Ω	< 100							
Full Scale Output Voltagea	Vpk	±2							
Insulation Resistance (@100vdc)	MΩ	> 100							
Excitation Voltage	Vdc	8 ~ 36							
Excitation Current	mA	< 5							
Physical Properties									
Weight (Cable Not Included)	Grams	16							
Mounting Torque	lb-in (Nm)	6 (0.7)							
Turn On Time	mSEC	<100							
Housing Material	Titanium Alloy								
Humidity	Hermetic Weld Seal								
Output Method	IEPE Output								

## Random Accessories

HS002	M3x16 Socket Head Cap Screws	2pcs Included
HS003	Ø3 SST Washer	2pcs Included
CR001	LEMO FGG-1B-307 Connector	Optional
AM005	8 Channels Data Acquisition System	Optional

## Optional Cables

13M2 Cable	Single-axis Accelerometer Cable With 4-pin Connector, 1 Meter Length	Optional
------------	--	----------

## Ordering information:

### P80AS

### GGGG

Range

0002=2g

0005=5g

0010=10g

0020=20g

0030=30g

0050=50g

0100=100g

0500=500g

E.G :

P80AS-2

Model P80AS, 0002, Connector, No Options

The data contained in this document is intended for the use of technical trainers only.

The customer's technical department is responsible for assessing the suitability of the product for the intended application and the completeness of the product information given in this document in relation to such application. For further information on products, technology, terms and conditions of delivery and prices, please contact our nearest office ([www.senstechxyz.com](http://www.senstechxyz.com)).

中国大陆

西安鑫源宇通电子科技有限公司

陕西省西安市高新区锦业路70号航天  
恒星云园区1号厂房一层南

Tel : 400-780-9688

[sales@senstechxyz.com](mailto:sales@senstechxyz.com)

中国香港

深大实业有限公司

香港新界沙田安平街6号新贸易  
中心B座13楼06室

Tel : +86 17792099916

[info@caltropinstruments.com](mailto:info@caltropinstruments.com)

新加坡

深大实业有限公司

香港新界沙田安平街6号新贸易  
中心B座13楼06室

Tel : +86 17792099919

[info@senstechxyz.com](mailto:info@senstechxyz.com)



西安鑫源宇通电子科技有限公司 | 400-780-9688

鑫源宇通——专业的传感和系统解决方案供应商

[www.senstechxyz.com](http://www.senstechxyz.com)

The contents of this manual may be updated from time to time due to product version upgrades or other reasons.

Unless otherwise agreed, this manual is intended as a guide to use only, and all statements, information and recommendations in this document do not constitute any warranty, express or implied.