



Model Y32AS is an industrial IEPE accelerometer permitting vibration measurements. Y32AS features an annular shear ceramic crystal which exhibits excellent output stability over time. The accelerometer incorporates an internal circuit with in a two-wire IEPE system which transmits its low impedance voltage output through the same cable that supplies the constant current power. Signal ground is internal shielded and isolated from the outer case of the unit. Polarity inversion protection for the amplify circuit is inherent in the circuit design. The welded stainless-steel construction provides a hermetic housing. The standard MIL-C-5015 glass insulated connector provides long-term stability over the operating temperature range. In addition to adhesive mounting, Y32AS has 1/4-28 threaded holes for stud mounting on the test object. The Y32AS provides wide frequency response and shock resistance, which is ideal for industrial vibration monitoring under incidental shock environment. Caltrop Instrument's model 16-L is a MIL-C-5015 connector mating cable for the sensor.

Features:

- Rugged design
- Corrosion resistant
- Hermetic seal
- Case isolated
- EMI / RFI shielded
- Shock resistance
- Wide frequency response

Application:

- Windmill machine
- Gear box monitoring
- Bearing detection
- Machine monitoring

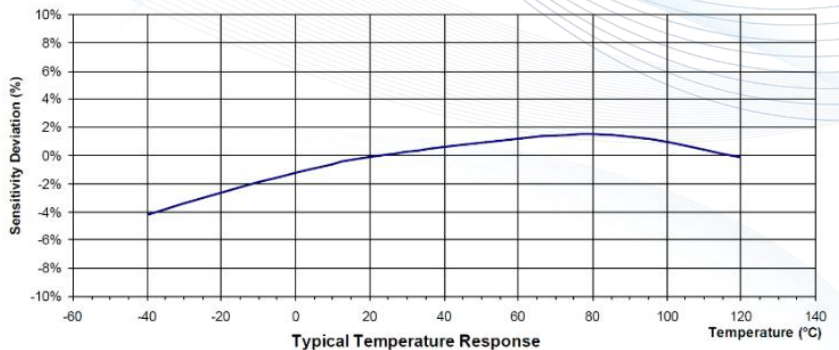
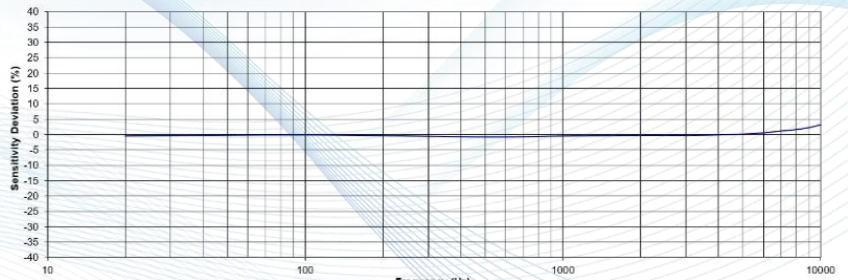
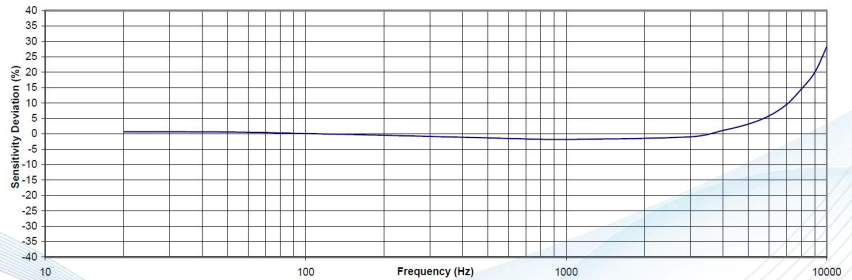
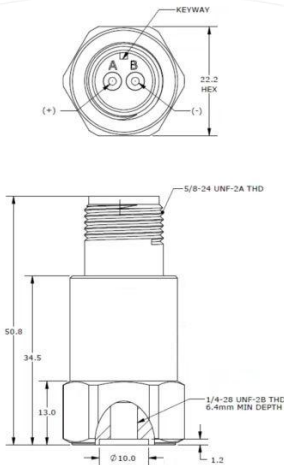

Specification:

Dynamic Performance	Unit	-5-LF	-10-LF	-20	-80	-500
Measurement Range	g, peak	±5	±10	±20	±80	±500
Sensitivity±10%	mV/g	1000	500	250	100	10
Frequency Range ±5%	Hz	0.3~4000	0.3~4000	1~7000	1~7000	1~7000
Frequency Range±3dB	Hz	0.1~10000	0.1~10000	0.5-13000	0.3~13000	0.3-13000
Resonant Frequency	kHz	20	20	32	32	32
Transverse Sensitivity	%	<5				
Non-Linearity	% FSO	±1				
Shock Limit	g	2000	2000	5000	5000	5000

Environmental Parameters

Temperature Sensitivity Coefficient -55 to +125°C	%	±10				
Operating And Storage Temperature	°C	-55~+125°C				

Electrical Characteristics

Bias Voltage	Vdc	10 ~ 14				
Output Impedance	Ω	< 100				
Insulation Resistance (@100vdc)	MΩ	> 100				
Excitation Voltage	Vdc	18 ~ 30				
Excitation Current	mA	2~10				

Physical Properties

Sensing Element	Piezo Ceramic (Shear)
Housing Material	316L Stainless Steel
Humidity	Hermetically Sealed
Output Method	IEPE Output
Connector	2 Pin MIL-C-5015

Random Accessories

HS004	Mounting Stud ¼-28 to ¼-28 Thread	One Stud Included
HS005	Mounting Stud ¼-28 to M6 Thread	
HS006	Mounting Stud ¼-28 to M10 Thread	
IS006	Magnet Mounting Adapter	Optional
AM003	3 Channel IEPE Signal Conditioner	Optional
AM004	Portable Vibration Analyzer	Optional
AM005	8 Channels Data Acquisition System	Optional

Optional Cables

16A-10	10 Meter Cable With MIL-C-5015 Connector	Optional
16A-10-B	10 Meter Cable With MIL-C-5015 Connector To BNC Connector	Optional

Ordering information:

Y32AS

GGGG

Range

0005=5g

0010=10g

0020=20g

0080=80g

0500=500g

E.G :

LF= Low frequency Response , Blank= Standard FR

Y32AS-0500

Model Y32AS, 500g, Connector, Standard FR

The data contained in this document is intended for the use of technical trainers only. The customer's technical department is responsible for assessing the suitability of the product for the intended application and the completeness of the product information given in this document in relation to such application. For further information on products, technology, terms and conditions of delivery and prices, please contact our nearest office (www.senstechxyz.com).

中国大陆

西安鑫源宇通电子科技有限公司
陕西省西安市高新区锦业路70号航
天恒星园区1号厂房一层南
Tel: 400-780-9688
sales@senstechxyz.com

中国香港

深大实业有限公司
香港新界沙田安平街6号新贸易
中心B座13楼06室
Tel: +86 17792099916
info@caltropinstruments.com

新加坡

深大实业有限公司
香港新界沙田安平街6号新贸易
中心B座13楼06室
Tel: +86 17792099919
info@senstechxyz.com



西安鑫源宇通电子科技有限公司 | 400-780-9688

www.senstechxyz.com

鑫源宇通——专业的传感和系统解决方案供应商

The contents of this manual may be updated from time to time due to product version upgrades or other reasons.

Unless otherwise agreed, this manual is intended as a guide to use only, and all statements, information and recommendations in this document do not constitute any warranty, express or implied.